

XL

HIGH CAPACITY PASSTHROUGH DISHWASHER

WASHTECH®



STANDARD FEATURES

- 40, 60 and 90 second dishwashing cycles
- 2.2L per cycle water consumption
- Compatible with 500mm to 600mm racks
- Powerful 1.5HP wash pump
- Washes up to 1,620 dishes per hour
- Washtech hybrid controls
- Hands-free auto-drain with drain pump
- Dual chemical pumps
- Heavy duty stainless steel wash manifold and arms
- Stainless steel scrap tray and wash/drain filter

Includes

- 1x 600mm GN tray rack (600 70042)
- 1x 500mm dish rack (600 70028)
- 1x 500mm cup rack (600 70029)
- 1x cutlery basket (C660508)
- 1x cutlery container (C660503)
- Connection kit (all hoses)

SPECIFICATIONS

A - Hot Water

Temperature	65°C
Connection	3/4" male, hose supplied
Pressure	200-350kPa
Flow	20L per minute
Backflow prevention	Atmospheric vacuum breaker
Consumption	2.2L per cycle*

D - Drainage

Drain pump flexi-hose	25mm
-----------------------	------

C - Electrical	V	Hz	A/ph	Max kW
Three phase	400-415	50	15	10.80
Single phase	230-240	50	15	3.60
Single phase	230-240	50	25	6.10

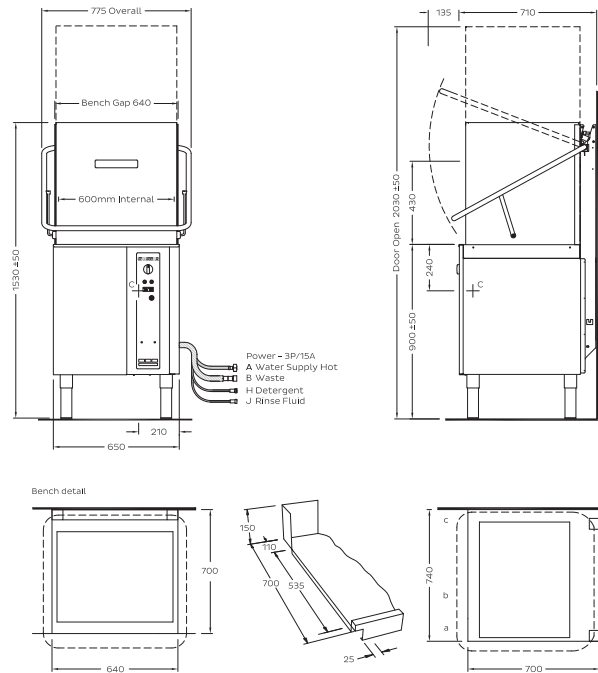

Dimensions

	Machine	Packed
Width (mm)	775	760
Depth (mm)	710	820
Height (mm)	1530	1460
Weight (kg)	120	141
Volume (m3)		0.91

Water Quality

	Min	Max
pH	7	8
TDS	1	135
Cl-		100
SO4		400
Fe		0.1
Mn		0.5
Cu		0.05
Cl2		0.1

*Water consumption rates may vary based on site conditions
Isolating switch must be within 1m of, and not directly behind, the machine
Refer to operator manual for installation instructions

Corner installation: machine must face left for access to controls; allow 300mm front clearance for service access; and splashback return <150mm.

In line with policy to continually develop and improve its products, Washtech reserves the right to change specifications and design without notice.



moffat.com.au | 1300 269 801

Manufactured in New Zealand by Washtech Limited - Distributed in Australia by Moffat PTY Limited
© Copyright Washtech Limited / Washtech XL Series-3 / WXL0040 / Jan-25

an Ali Group Company



the spirit of excellence